

DAYTONA

4V
ANIMA
DAYTONA

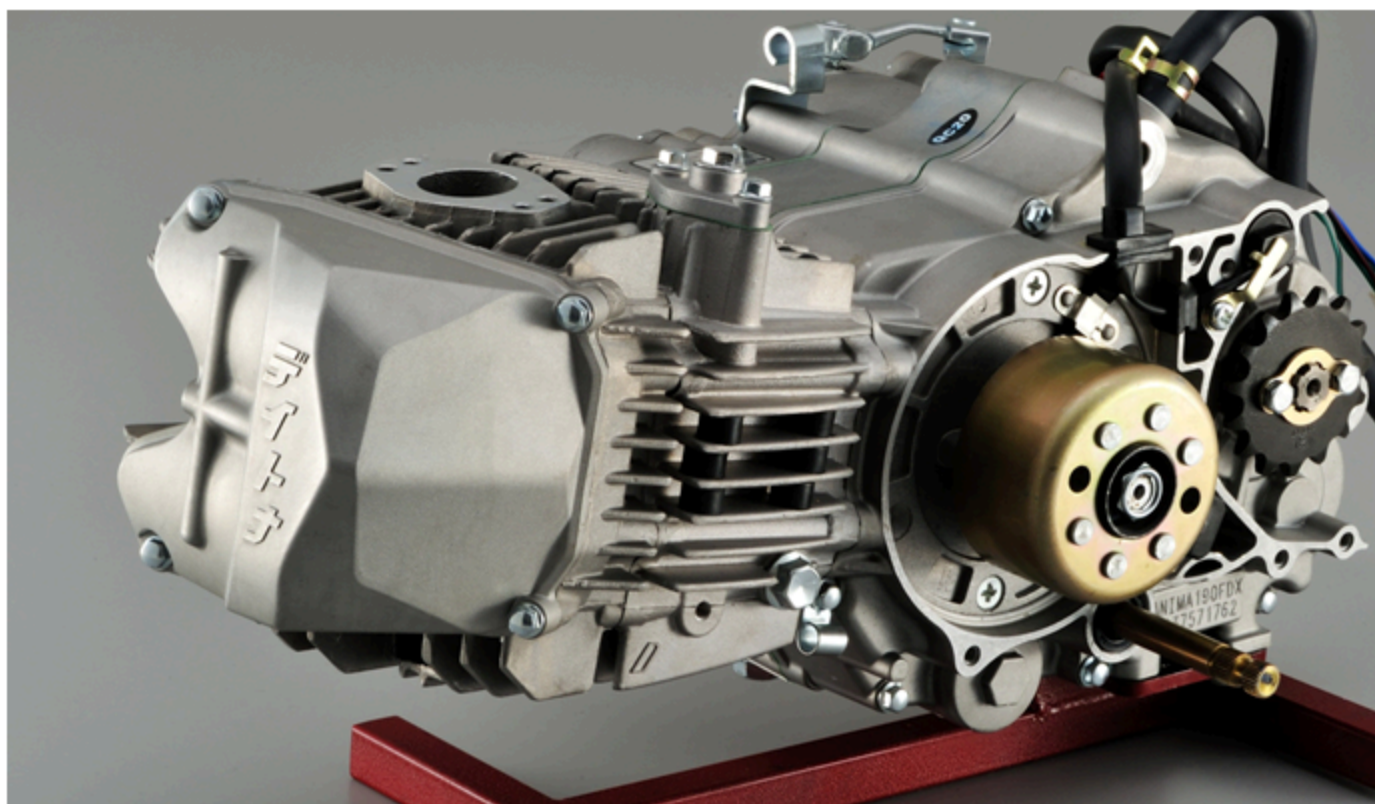

**RACING ENGINE
OPTION PARTS CATALOG**

ANIMA-4V ENGINE MODELS

Part # MODEL NAME	81281 190GP5	80733 190SYS	88018 190FSM
	<p>Stay in Control, Corner After Corner.</p> <p>Specially optimized Gearbox keeps you in the ideal RPM range for better control through tight corners and straight.</p>	<p>High-revving Power, Sharp response.</p> <p>It responds instantly to your input, quickly reaching High-Rev Power.</p>	<p>The Standard. Steady Power Delivery</p> <p>The ϕ 62x62 Square stroke ensures stable Torque and Power from low to high RPM.</p>
Displacement Bore x Stroke	189.9cc ϕ 66x55.5 Short-Stroke	189.9cc ϕ 66x55.5 Short-Stroke	187.2cc ϕ 62x62 Square-Stroke
Transmission Shift pattern Type Gear Ratio	5speed 1-N2345 GP/Motard Close-Ratio	4speed N-1234 Standard Wide-Ratio	4speed N-1234 Standard Wide-Ratio
Starting Method	Kick	Kick	Kick
Flywheel type Features	Lightweight Quick response, High-RPM performance	Lightweight Quick response, High-RPM performance	Lightweight Quick response, High-RPM performance
CDI type Ignition timing Option Rev limit Option	Single Advance CDI - -	Single Advance CDI - -	Single Advance CDI - -
Camshaft type	High-RPM	High-RPM	High-RPM
Auxiliary Output	Without	Without	Without

88392

190FE

89202

190FZ5

88025

160FSM

87371

190FDS**One switch,
Easy Ride****Get ready for an
adventure!****Race-Proven Power,
Performance 160****Our only one
Dry-sump engine**Easy Start & Ride
with a Starter motor.With a 95W generator
for headlight output
and the reliable power.Built for power and
performance.
With years of proven
results, this engine is
your key to victory
in the 160cc class races.Designed for pure Fun,
With no transmission
and no clutch,
it's all about the
fun of simplicity.**187.2cc**φ 62x62
Square-Stroke**187.2cc**φ 62x62
Square-Stroke**159.7cc**φ 62x52.9
Short-Stroke**187.2cc**φ 62x62
Dry-sump**5speed**

1-N2345

Standard
Wide-Ratio**5speed**

1-N2345

Standard
Wide-Ratio**4speed**

N-1234

Standard
Wide-Ratio**DirectDrive****E-start
&Kick****Kick****Kick****Without****Heavy**Low-end Torque,
Less Stalling**Heavy**Low-end Torque,
Less Stalling**Lightweight**Quick response,
High-RPM performance**Heavy**Low-end Torque,
Less Stalling**Multi-Setting Advance CDI**4 Timings
5 RPM limits**Multi-Setting Advance CDI**4 Timings
5 RPM limits**Single Advance CDI**-
-**Single Advance CDI**-
-**Low-Mid****High-RPM****High-RPM****High-RPM****MAX84w**

Lighting ready

MAX95w

Lighting ready

Without**Without**

Which ANIMA we recommend for you?

Do you want to use electrical starter motor ?

YES

With Electric starter model.

190FE

Only one with starter motor model.
5speed. $\Phi 62 \times 62$ mm stroke,
212cc Bore-up compatible.

NO

Do you want to use electrical components (lights, meters, etc.) ?

YES

With Light output model.

190FE or 190FZ5

FE : Max 84W output, with starter motor.
FZ5 : Max 95W output, kickstart.
Both are 5speed models.
212cc Bore-up compatible.

NO

What is the main purpose?

For Racing

Using 190cc & Planning to bore up in the future.

**$\Phi 62 \times 62$ mm
Steady Power.**

190FSM

$\Phi 62 \times 62$ mm Square stroke, 4speed.
212cc Bore-up compatible.

Using 190cc only, no bore up planned.

**$\Phi 66 \times 55.5$ mm
High-revving.**

190GP5 or 190SYS

GP5 : 5speed close ratio transmission.
SYS : 4speed transmission.
 $\Phi 66 \times 55.5$ mm short-strokes.
212cc Bore-up not compatible.

Limited to 160cc.

**For 160cc
Regulations.**

160FSM

$\Phi 62 \times 52.9$ mm, 4 speed.
For 160cc regulations.

For Special applications (kart, snow bike, paramotor, etc.)

**Dry-sump,
Lightweight.**

190FDS

Without clutches, transmissions.
 $\Phi 62 \times 62$ mm stroke, Dry-sump engine.



Plug & Play Ultralight Clutch

- Reduced clutch lever effort for smoother operation.
- More direct and precise clutch control with no loss from cable stretch or wear.
- Complete kit for hydraulic conversion.

— Kit Contents —

- Clutch cover with slave cylinder.
- Specially designed oil filter cover.
- 100 cm hydraulic hose & Banjo bolts
- Hydraulic Clutch master cylinder
- O-rings

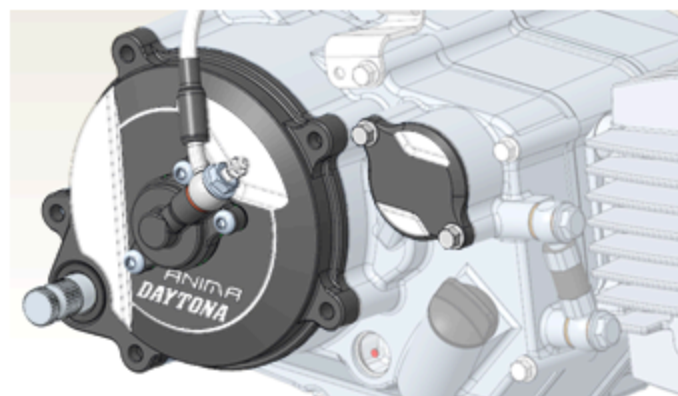

#81376

Reinforced & Lightweight Crankshaft Assy for ANIMA 4V 190 4speed , 62mm Stroke

**Lightweight,
Sharp Response.**



9% stronger
against whip momentum.

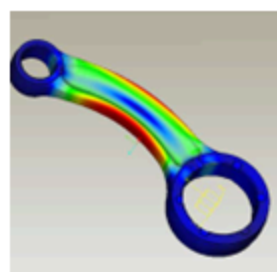

8% stronger
against piston kinetic load.



- 9% Lightweight Crank makes sharp response and improved acceleration.
- High Strength Connecting Rod Manufactured with premium Daido Steel (Japan).
- Premium Side Bearings with JTEKT bearings, made in Japan.

212cc Kit, for ANIMA190SYS 4speed 62mm Stroke

- 212cc Stroke up kit for ANIMA190SYS 4-speed model.
- Comes with Upgrade 62mm Lightweight Crankshaft and DLC Piston pin, all parts needed for 212cc conversion.
(Crankshaft / Piston / Rings / DLC Pin / Clips / Gaskets)

KIT#	Description	Comp Ratio
#81379	Kit with STD Comp Piston	11.7 : 1
#81380	Kit with High-comp Piston	12.3 : 1



66mm BORE-UP KIT, 212cc



- **Low-Friction Nikasil-Coated All-Aluminum Cylinder**

The Nikasil coating cylinder enhances durability and reduces friction, ensuring efficient and high-performance.

- **Stable Performance, Superior Heat Dissipation**

Our all-aluminum cylinder delivers optimal cooling even under increased heat from bore-up.

**** All our engines feature all-aluminum cylinders.*

KIT#	Comp Ratio	Application	Description
#81227	12.3 : 1	ANIMA 190F (Φ62 x 62mm)	with High-compression Piston with DLC Piston pin
#80117	11.7 : 1		with 212cc Standard piston

FORGED PISTON KIT



- **Forged Strength & Low Friction**

Forged piston and DLC-coated pin for maximum durability and smooth performance.

KIT#	Bore	Application	Compression Ratio
#88888	Φ66	ANIMA 212cc Bore-up	High-compression 12.3 : 1 (Standard = 11.7 : 1)
#80119	Φ62	ANIMA 190F (Φ62 x 62mm)	High-compression 13.65 : 1 (Standard = 12.1 : 1)
#80120			Standard 12.1 : 1
#80119	Φ62	ANIMA 150F (Φ62 x 49.5mm)	Standard 12.1 : 1



**Designed for
the Circuit.**
**Launch out of corners
Faster than ever.**

- Built for aggressive track riding.
- Keeps the engine in the ideal power band.
(8,500–10,000 rpm)
- Final ratio is the same as the original 4-speed.

***Compatible only with 4-speed engines.*

*Not suitable for 5-speed engines
due to crankcase width differences.*

SPEED COMPARISON		
Vehicle Speed @ 11,900 RPM		
Gear	Original 4-Speed	Close Ratio 4-Speed (#81388)
1 st	39.77 km/h	48.76 km/h
2 nd	60.01 km/h	70.59 km/h
3 rd	80.02 km/h	87.38 km/h
4 th	99.69 km/h	99.69 km/h

- Final Drive Ratio : 15T / 39T
- Tire Diameter : 12 inch
- Calculated at limiter RPM (11,900 rpm)

Close-Ratio Acceleration Simulation

Shift Points : 10,500 RPM

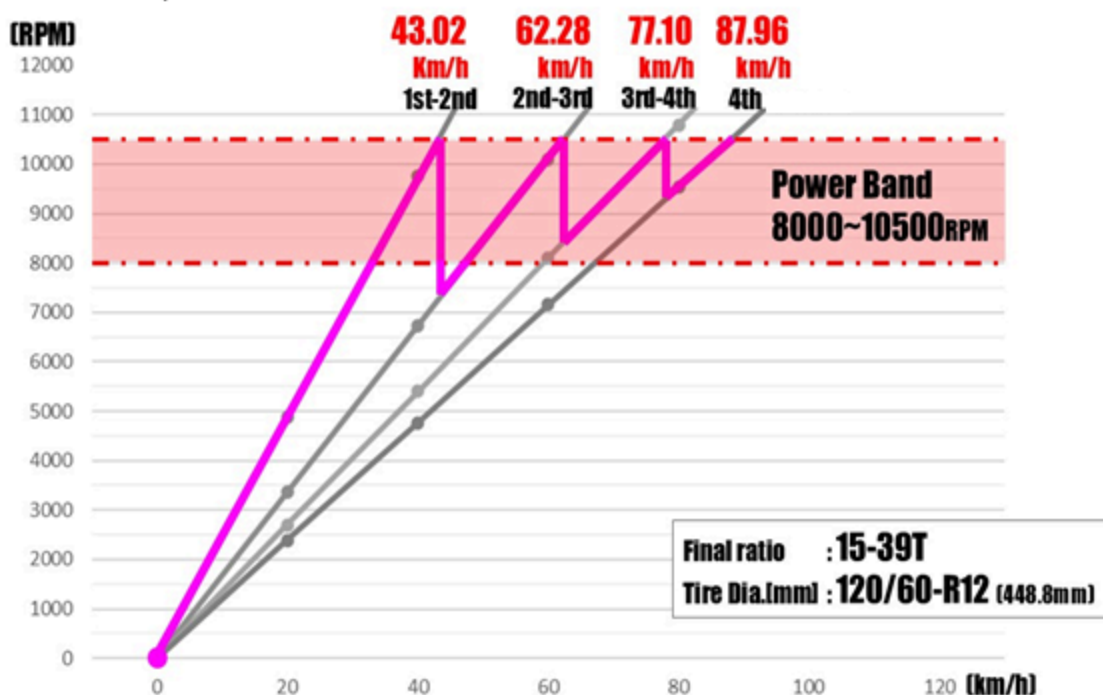

#81122 CNC CLUTCH BASKET, HARD ANODIZED



- 7075-T6 CNC Hard-anodized Basket with laser marked logo.
- Can be used with DAYTONA/ EVR/STM Slipper-Clutch Kit.
- Primary gear 67T
**Original size

Strength-optimized oval design.



#81399 OVERDRIVE PRIMARY GEAR KIT (65-19T)



+9% top-end speed — for riders who want to go faster.

- Ideal for those who want to push each gear further and reach higher speeds on long straights or fast tracks.
- Changes primary reduction ratio from original 67-18 (3.722) to High-geared 65-19 (3.421)
Theoretical 9% increase in top speed per gear, offering a longer gear ratio.
- CNC Clutch Basket – Strength Analyzed & Race Proven
Made from high-strength aluminum with hard anodized finish for superior durability
Precision CNC-machined with optimized geometry for strength and performance.

#81289

SLIPPER & ASSIST CLUTCH KIT



● When Downshifting :

Optimized Engine Braking & Anti-Rear Hopping

Prevents rear-wheel hop during downshifts while maintaining effective engine braking for better control.

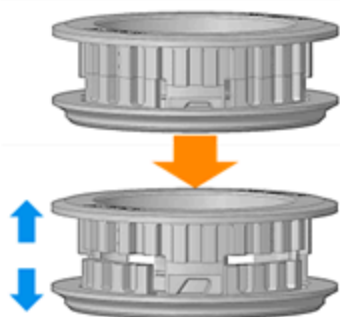

● During Accelerating :

Maximum Acceleration, No loss of Power

The two parts lock together to improve clutch engagement and provide strong, stable power transfer.

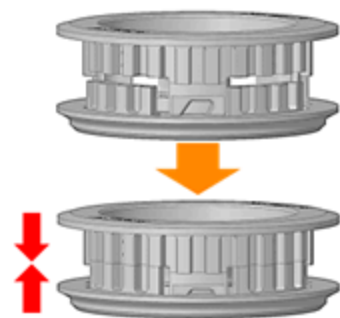

● Simple Bolt-On Installation :

Direct replacement for stock clutch components.
Replacement clutch plates included.

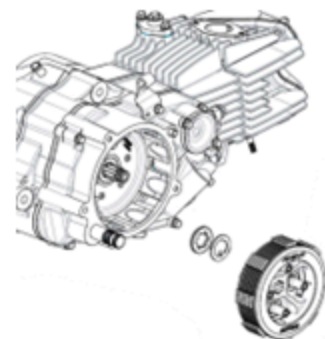

#81528 F.C.C. REINFORCED CLUTCH FRICTION DISC SET

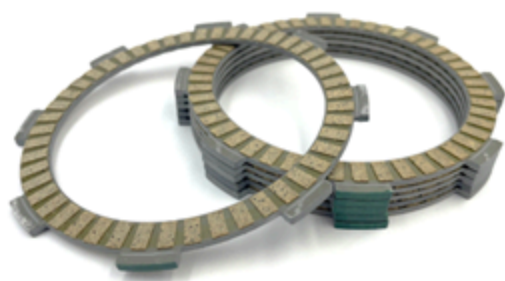

- High-quality friction disks made from Paper and Kevlar.
- Manufactured by F.C.C. Japan.
- Delivers smooth and reliable clutch engagement even under high loads.

CLUTCH SPRING 4PCS/SET (HARD +25% or +40% / SOFT -20%)



PN#	Remarks	Recommend for
#81057	HARD, +25%	with Standard clutch system. (without slipper clutch)
#81330	HARD, +40%	Improve power transfer.
#81302	SOFT, -20%	with Slipper Clutch(PN#81289) Increasing the slip effect.

#80910 PRESSURE PLATE HOLDING TOOL

- Special tool for easily removing locknut. Four pawls hold the clutch pressure plates.



#80221 LOCK NUT TOOL 1/2"SQ.DR.

- Special tool for removing clutch lock nut.
- Could be use 1/2 size impact & handle.



****C-rings will no longer be included, due to the growing use of impact wrenches with built-in locking systems.*

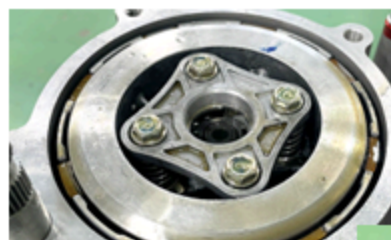

HOLDING TOOL(#80910) and LOCK NUT TOOL(#80221) use in combination.



ULTRALIGHT ALUMINUM CLUTCH PLATE KIT

- Faster Rev-Up with lightweight aluminum plates.
- Weight **-40%**
- Made from Aluminum with Hard-anodized.
- Ideal for:
 - Track riding
 - High-revving lover



KIT# Kit Contents

#81943	x 5 Aluminum plates x 6 OEM Friction disks
#81944	x 5 Aluminum plates x 6 Upgrade F.C.C. Friction disks
#81945	x 5 Aluminum plates only

*Total weight of Friction disks(6pcs) + Plates(5pcs)

With OEM STEEL PLATES	With ALUMINUM PLATES
350g	210g (-40%)

#81963 TITANIUM VALVETRAIN KIT

- **40%** Lightweight Titanium Intake valve & Retainer kit for High-revving riders.
- Standard OEM size valves. (IN ϕ 24.5 / EX21 mm)
- Recommended replacement interval: **10 hours**.
(Proven performance for 20+ hours in testing)
- All-in-one kit for upgrade

Upgrade items

- x2 Titanium Intake valves,
- x4 Titanium retainers.

Replacement items

- x2 Exhaust valves,
- x4 Springs,
- x8 Cotter pins,
- x4 Seals,
- x4 Seats,
- x2 shims for Intake



#81861 CAMCHAIN TENSIONER, SCREW LOCK TYPE



- Chain tensioner for more precise tension adjustment.
- Adjust the tension by turning the dial at the tip of the tensioner.



#81480 CAMSHAFT DT190-2 with ISONITE TREATMENT



- Special ISONITE-treated "DT190-2" (#81479) camshaft.
- Enhanced durability and smoother operation.
- Easy Installation, Just replace your stock one.

#81217 TITANIUM VALVE RETAINER 4pcs/set

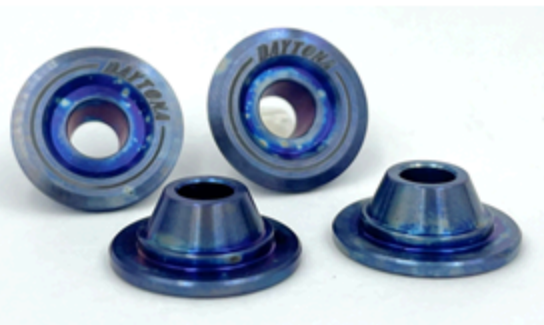

- Lightweight valve retainer for High-rev performance.
- Made from Titanium : Ti-6Al-4V with Nitriding coat.

#81055 HEAD GASKET, HIGH-COMPRESSION 0.15mm



- 0.1mm thinner head gasket.
(Stock = 0.25mm / #81055 = 0.15mm)
- Compression ratio : 11.91 : 1 (Stock = 11.7 : 1)
※with 190cc stock piston & 0.15mm gasket

CNC SHIFT SHAFT STABILIZER

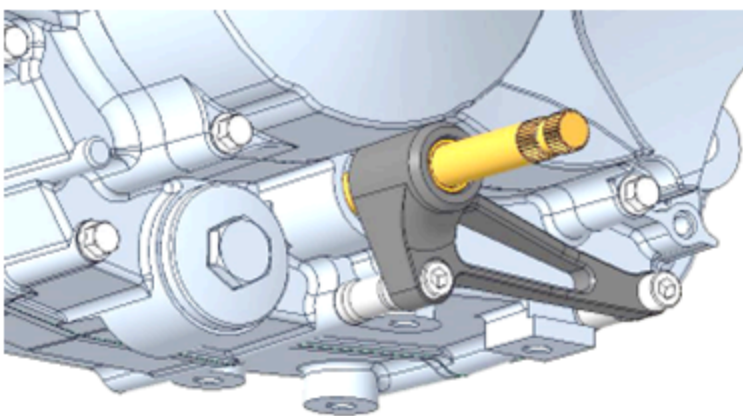

- **Shaft Protection with Direct Shift Feel.**

This is to prevent the shaft from bending when tipping over, but now, your shaft is fixed! It provides pleasant shift feeling.

- **Easy Installation, Bolt-on design.**



#81237 ANODIZED BLACK



#81364 ANODIZED TITANIUM

CNC NON-FLEX CLUTCH CABLE GUIDE (HIGH or LOW)

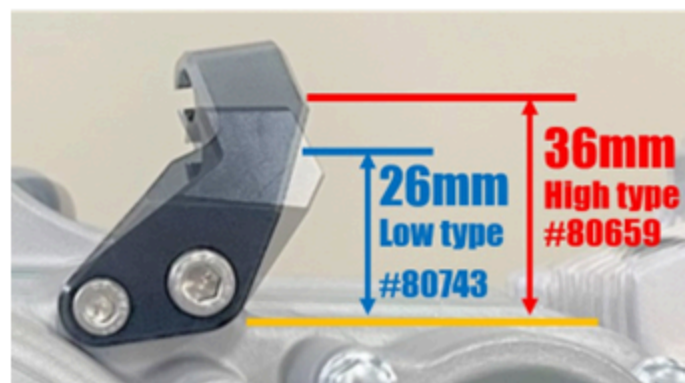

- **More Direct and Responsive Clutch Control.**

Non-flex CNC guide delivers a sharper, more controlled clutch feel.

- **Smooth Cable Pull, Less power.**

Aligned with the clutch lever's rotation for smoother pull and seamless operation.

- **"Low-type" is designed to less interference with the exhaust pipe.**



#80659 High type
#80743 Low type

TEIKEI MV-33 CARBURETOR KIT

Easy Set Up with Smooth Power

KIT#	Description
------	-------------

#89874



Carb kit, Manifold without hole
For standard fuel system.

#88824



Carb kit, Manifold with hole
For Negative pressure fuel system.
Hole size : M10 P=1.25

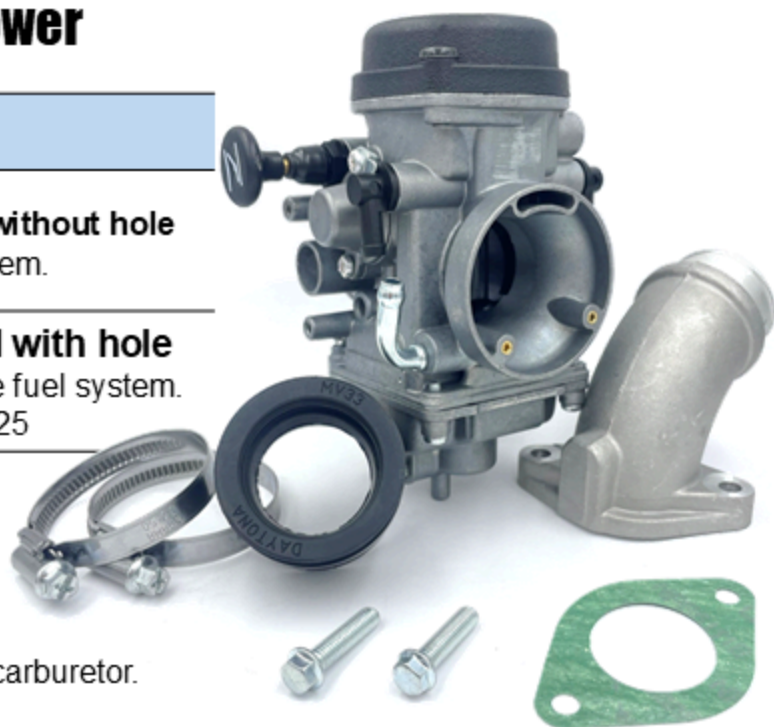

- Ready for Riding,
Factory pre-set for 190cc / 212cc.
- Smooth and Controllable Vacuum-type carburetor.

OPTION ACCESSORIES for TEIKEI MV33



#88859
THROTTLE WIRE
1500MM 6X6



#88860
WIRE ADJUST BOLT



#88861
CABLE END SET

#81530 POWER ADVANCE AIR FILTER for 52.1mm Fitting Carburetors



- High-Flow Air filter for 52.1mm Fitting Carburetors.
- Fitting size = OD ϕ 52.1mm (for MV33 / PE28 and others)
- Size = Top 75mm x Bottom 75mm x H49mmD
ID ϕ 52.1mm

#81188 MAIN JET SET 10 pcs/kit for TEIKEI MV33



- Main jet 10 pcs /kit
#122 / 125 / 126 / 128 / 129 / 132 / 134 / 135 / 136 / 145
- Stock size (#130) is not included.

INTAKE MANIFOLD KIT

- The kit includes a 15° sloped manifold offering a near-downdraft effect, along with a vibration-resistant tube-type rubber.



KIT#	Application	Manifold type
#80020	KEIHIN PWK33	Without hole
#80018	KEIHIN PE28	Without hole
#88253		With hole



● Without Hole

For standard fuel system.



● With Hole

M10 P=1.25
For Negative pressure fuel system.

#87577 DID CAM CHAIN 94L



- Smooth operation and durability chain.
- 94 links
- Made by DID Japan
- Made in Japan

#89522 DID STARTER CHAIN 66L for ANIMA FE (E-start model)



- Smooth operation and durability chain.
- 66 links
- Made by DID Japan
- Made in Japan

#87235 OUTER ROTOR KIT for ANIMA 4V KICKSTART MODEL



- Lightweight outer rotor kit for sharp engine response.
- With selectable Ignition timing full digital CDI.
- Kit Rotor weight : 610g / Output 45W/6000rpm
 - Stock Big Rotor : 745g (FDX, FLX type)
 - Stock Small Rotor : 625g (FSM, SYS type)

#32410 TAPPET ADJUST WRENCH 8mm & 9mm REVERSIBLE



- Special tool for adjust valve clearance.
- Reversible design 8mm & 9mm.

#75252 CARBURETOR PIN CLEANER



- Narrow pin set for carburetor jet cleaning.
- 10 brushes from $\varnothing 0.4$ to $\varnothing 1.6$ mm.
(0.40 / 0.45 / 0.50 / 0.55 /
0.60 / 0.65 / 0.80 / 1.0 /
1.2 / 1.6mm)



#15614 CARBURETOR CLEANING BRUSHES



- Narrow brush set for carburetor cleaning.
- Includes 5 brushes from $\varnothing 2.5$ to $\varnothing 6.5$ mm.
($\varnothing 2.5$ / 3.5 / 4.5 / 5.5 / 6.5mm)





#80384 Black



#80385 Red



#80386 Orange



#80388 Green



#80387 Blue

CNC STRAINER COVER

***This cover does not fit Anima FE.
(with Starter motor model)*

- CNC machined aluminum cover
- With laser printed "DAYTONA" logo.
- With replace O-ring.



#80389 Black



#80390 Red



#80392 Blue



#80393 Green



#80391 Orange

CNC OIL FILTER COVER

- CNC machined aluminum cover.
- With laser printed "DAYTONA" logo.
- With replace O-ring.



#80394 Black



#80397 Blue



#80396 Orange



#80398 Green



#80395 Red

CNC OIL FILLER CAP

- CNC machined aluminum oil filler cap.
- With laser printed "DAYTONA" logo.
- With replace O-ring.

MAGNET OIL DRAIN BOLT M12-P1.5

#93751 SILVER

#81014 BLUE

#81015 RED



- Say goodbye to floating metal bits
— this bolt grabs them before they do harm.

*** Silver: fully drilled (all sides).*

*** Blue & Red : drilled on two sides for safety wire.*

GASKET SET / SEAL SET for ANIMA 4Valve (150F/160F/190F/190S/212)

- All in one simple kit. Zero-stress!

**#88710
GASKET SET**



**#81447
SEAL SET**





COMPANY OVERVIEW

Company Name	DAYTONA CORPORATION
Address	4805 Ichimiya, Mori-machi, Shuchi-gun, Shizuoka, 437-0226 Japan
Foundation	April 1972
President	Tetsuji Oda
Capital	JPY412,000,000
Business Domain	Market Researching, Planning, Developing, Testing, Procurement, and Logistics Management of Motorcycle parts and accessories.



MESSAGE FROM THE PRESIDENT



DAYTONA was established in 1972 and ever since then, we have been trying to create rider-friendly products by pursuing the needs of riders and understanding how to provide them with enjoyable riding conditions.

The R&D team is made up of motorcycle enthusiasts who are always aiming at developing needed products to support riders.

DAYTONA is a top brand name in Japan, assisted by many customers and suppliers.

We hope that all motorcycle lovers around the world would have a chance to use our products and experience what we are able to create.

Truly yours,
Tetsu, Tetsuji Oda

Global site



Distributors
(Engine)



Instagram

